

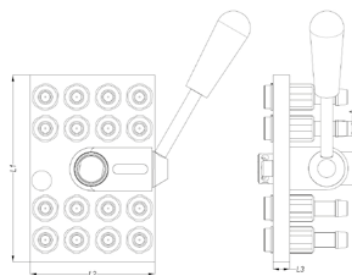

MOULDPRO

COUPLING PLATE - WITH VALVED COUPLERS



Part Code	# Circuits	# Connection	A	L1	L2	L3
MC4-10	4	8	10	102	104	14
MC4-13	4	8	13	102	104	14
MC6-10	6	12	10	154	78	14
MC6-13	6	12	13	154	78	14
MC8-10	8	16	10	154	104	14
MC8-13	8	16	13	154	104	14
MC10-10	10	20	10	206	104	14
MC10-13	10	20	13	206	104	14
MC12-10	12	24	10	240	104	14
MC12-13	12	24	13	240	104	14

COUPLING PLATE – WITH VALVED COUPLERS

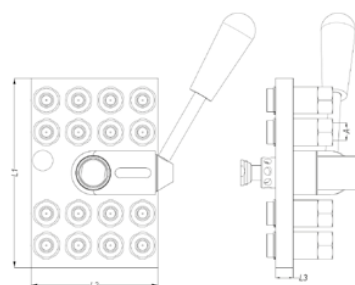

Part Code	# Circuits	# Connection	A	L1	L2	L3
MC4-3/8	4	8	G3/8	102	104	14
MC6-3/8	6	12	G3/8	154	78	14
MC8-3/8	8	16	G3/8	154	104	14
MC10-3/8	10	20	G3/8	206	104	14
MC12-3/8	12	24	G3/8	240	104	14

COUPLING PLATE - WITH INLET AND OUTLET FEMALE COLLECTOR

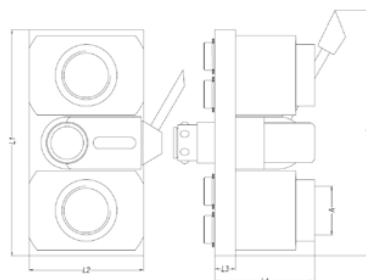

Part Code	# Circuits	# Connection	A	L1	L2	L3
MC6-1	6	12	G1"	154	78	14
MC10-1-1/4	10	20	G1-1/4"	206	103	14
MC12-1-1/4	12	24	G1-1/4"	230	103	14

MULTICOUPLERS

MOULD PLATE - WITH MOUNTING HOLES

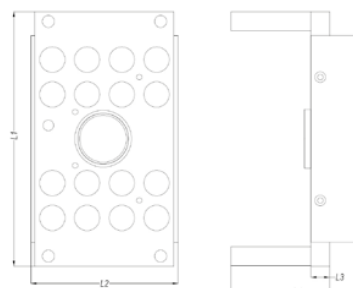

Part Code	# Circuits	# Connection	L1	L2	L3	L4
MM4-P	4	8	140	104	14	60
MM6-P	6	12	190	88	14	60
MM8-P	8	16	190	110	14	60
MM10-P	10	20	206	110	14	90
MM12-P	12	24	256	110	14	90

REPLACEMENT COUPLERS



Connection	Part Code	Part Code	Part Code
Ø 10	MC-C10	MC-C10P	
Ø 13	MC-C13	MC-C13P	
G3/8"			MC-C3/8

REPLACEMENT NIPPLES



Connection	Part Code	Part Code	Part Code	Part Code
Ø 10			NC-C10	NC-C10P
Ø 13			NC-C13	NC-C13P
G3/8"	NC-C3/8	NC-C3/8		

MATERIAL EPDM

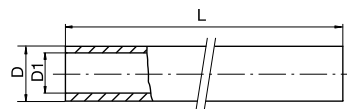
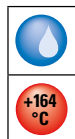

Part No.	D1	D	L	Colour	Pressure	
E10B	10	16,5	50 m	Blue	max. 15 bar	1
E10R	10	16,5	50 m	Red	max. 15 bar	1
E10S	10	16,5	50 m	Black	max. 15 bar	1
E13B	13	21	50 m	Blue	max. 15 bar	1
E13R	13	21	50 m	Red	max. 15 bar	1
E13S	13	21	50 m	Black	max. 15 bar	1
E19B	19	27	30 m	Blue	max. 15 bar	1
E19R	19	27	30 m	Red	max. 15 bar	1
E19S	19	27	30 m	Black	max. 15 bar	1

MATERIAL EPDM

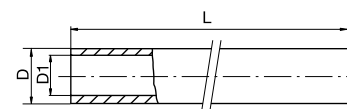
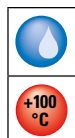

Part No.	D1	D	L	Colour	Pressure	
G10B	10	16,5	50 m.	Blue	Max 15 bar	1
G10R	10	16,5	50 m.	Red	Max 15 bar	1
G10S	10	16,5	50 m.	Black	Max 15 bar	1
G13B	13	21	50 m.	Blue	Max 15 bar	1
G13R	13	21	50 m.	Red	Max 15 bar	1
G13S	13	21	50 m.	Black	Max 15 bar	1
G19B	19	27	30 m.	Blue	Max 15 bar	1
G19R	19	27	30 m.	Red	Max 15 bar	1
G19S	19	27	30 m.	Black	Max 15 bar	1
G25B	25	35	20 m.	Blue	Max 15 bar	1
G25R	25	35	20 m.	Red	Max 15 bar	1
G38B	38	48	20 m.	Blue	Max 15 bar	1
G38R	38	48	20 m.	Red	Max 15 bar	1



See explanation of symbols on page 5

HOSES

MATERIAL NBR/PVC - PUSH LOCK HOSE

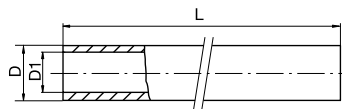
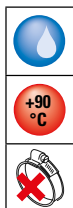

Part No.	D1	D	L	Colour	Pressure	
PL10B	10	16	50	Blue	Max 10 Bar	1
PL10R	10	16	50	Red	Max 10 Bar	1
PL10S	10	16	50	Black	Max 10 Bar	1
PL13B	13	20	50	Blue	Max 10 Bar	1
PL13R	13	20	50	Red	Max 10 Bar	1
PL13S	13	20	50	Black	Max 10 Bar	1

MATERIAL NBR

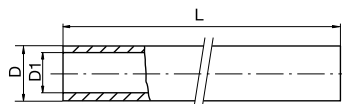
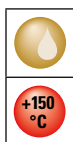

Part No.	D1	D	L	Colour	Pressure	
N10S	10	16,5	50 m		max. 15 bar	1
N13S	13	20	50 m		max. 15 bar	1

See explanation of symbols on page 5

MATERIAL PVC

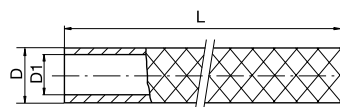
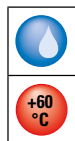

Part No.	D1	D	L	Colour	Pressure	
P10T	10	16	30 m		max. 15 bar	1
P10B	10	16	30 m		max. 15 bar	1
P10R	10	16	30 m		max. 15 bar	1
P13T	13	19	30 m		max. 15 bar	1
P13B	13	19	30 m		max. 15 bar	1
P13R	13	19	30 m		max. 15 bar	1
P19T	19	26	30 m		max. 15 bar	1
P19B	19	26	30 m		max. 15 bar	1
P19R	19	26	30 m		max. 15 bar	1

MATERIAL SILICONE

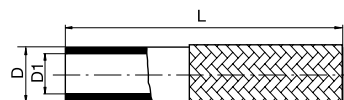
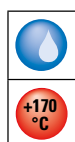

Part No.	D1	D	L	Colour	Pressure	
S10	10	15	25 m		max. 15 bar	1
S10B	10	15	25 m		max. 15 bar	1
S10R	10	15	25 m		max. 15 bar	1
S13	13	19	25 m		max. 15 bar	1
S13B	13	19	25 m		max. 15 bar	1
S13R	13	19	25 m		max. 15 bar	1

Description:
Stainless Steel Braided

MATERIAL FKM

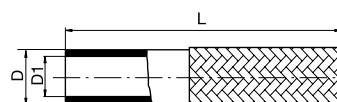
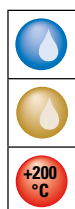

Part No.	D1	D	L	Colour	Pressure	
V10	10	15	25 m		max. 15 bar	1
V13	13	19	25 m		max. 15 bar	1

Description:
Stainless Steel Braided



See explanation of symbols on page 5

HOSES

PTFE HOSE ASSEMBLIES

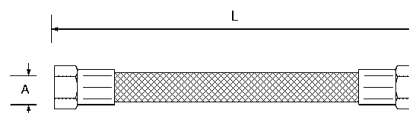
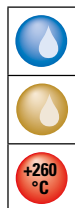

Part No.	A	L	Hose ID
T10300R1/4	1/4 BSPP	300	10
T10600R1/4		600	
T10800R1/4		800	
T101000R1/4		1000	
T101250R1/4		1250	
T101500R1/4		1500	
T102000R1/4		2000	
T10300M14	M14X1,5	300	10
T10600M14		600	
T10800M14		800	
T101000M14		1000	
T101250M14		1250	
T101500M14		1500	
T102000M14		2000	
T13300M16	M16X1,5	300	10
T13600M16		600	
T13800M16		800	
T131000M16		1000	
T131250M16		1250	
T131500M16		1500	
T132000M16		2000	
T13300R3/8	3/8 BSPP	300	13
T13600R3/8		600	
T13800R3/8		800	
T131000R3/8		1000	
T131250R3/8		1250	
T131500R3/8		1500	
T132000R3/8		2000	

Description:

Super Flex convoluted inner tube/ Stainless steel braided
Max 20 Bar pressure

See explanation of symbols on page 5

SAFETY HEAT SLEEVE



Part No.	ø (ID) mm	Length (roll)
SHS10	10	20 m.
SHS15	15	20 m.
SHS20	20	20 m.
SHS25	25	20 m.
SHS30	30	20 m.
SHS40	40	20 m.

Description:

Protect hoses/cables from heat exposure
 Material: Glass fiber with silicone coating
 Temperature: Up to +260°C continuous heat

SAFETY SLEEVE



Part No.	ø (ID) mm	Flat (mm)	Length (roll)
SS17	17	30	50 m.
SS23	23	40	50 m.
SS30	30	50	50 m.
SS39	39	65	50 m.
SS55	55	90	50 m.

Description:

Protect in case of burst hose
 Protect hose from abrasion
 Resistant to chemicals
 Polyester up to 120 degrees

SAFE-STRIP, STANDARD



Part No.	Length (mm.)	Bundle max (mm)	Strip Width (mm)
STD70	310	70	40
STD100	435	100	40
STD125	505	125	40
STD155	605	155	40
STD180	680	180	40

Description:

Safe-Strip made of polypropylene with Velcro fasteners

SAFE-STRIP, WITH MOUNTING EYELET



Part No.	Length (mm.)	Bundle max (mm)	Strip Width (mm)
STE70	340	70	40
STE100	455	100	40
STE125	540	125	40
STE155	660	155	40
STE180	765	180	40

Description:

Safe-Strip made of polypropylene with Velcro fasteners. With Eyelet

SAFE-STRIP WITH BUCKLE



Part No.	Length (mm.)	Strip Width (mm)
STB50	500	25
STB100	1000	25
STB150	1500	25

Description:

Safe-Strip made of polypropylene with quick-release buckle

HOSE CUTTING TOOL



Part No.	Size	
HC025	0-25 mm	1

Description:
For PVC and Rubber hoses only

SPARE BLADES





Part No.	Size	
HC-SB	One Size	1

HOSE CLAMPS

FERRULE

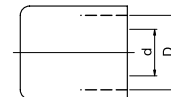
**STAINLESS
STEEL**



Part No.	D	d		Hose Ref.
C10/15	15	10	100	S10
C10/16	17	10	100	V10/P10/N10
C10/17	17,5	10	100	G10/E10
C13/19	19	13	100	S13/V13
C13/20	20	13	100	P13
C13/22	22,5	13	100	N13/G13/E13
C19/29	29	19	100	G19/E19

Description:

Ferrules made of Stainless Steel. Offers perfect and safe connections.

HAND CRIMPER



Part No.	Crimp Range (mm)	
X100	10-36	1

HOSE CLAMPS STANDARD TYPE

**STAINLESS
STEEL**

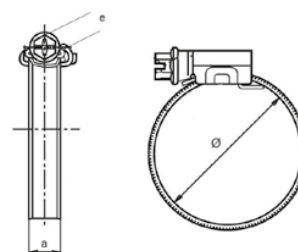

Part No.	Ø	e	a		Hose ref.
K10	8-16	7	9	50	S10/V10/P10/E10/G10/N10
K13	12-22	7	9	50	S13/V13/P13/E13/G13/N13
K19	20-32	7	9	50	P19/E19/G19

Description:

Material: Stainless steel (Screw: Mild steel, Zinc plated)

HOSE CLAMPS HEAVY DUTY

**STAINLESS
STEEL**

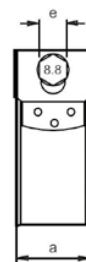
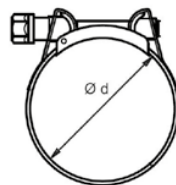

Part No.	Ø	e	a		Hose ref.
HDC2527	25-27	8	18	50	P19/E19/G19
HDC3437	34-37	11	20	50	G25
HDC4751	47-51	11	20	50	G38

Description:

Material: Stainless Steel

FLEXIBLE HOSE CLIP SCREWDRIVER



Part No.	A/F
SD01	7

Description:

Flexible screwdriver for hose clips
7 mm. A/F

TWO-EAR CLIP

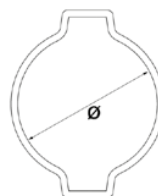

Part No.	Ø - ID	L		HOSE Ref
EAR15	13-15	7	100	S10/V10
EAR17	14-17	7	100	P10/N10
EAR18	15-18	7,5	100	E10/G10
EAR20	17-20	7,5	100	S13/V13/P13/N13
EAR23	20-23	8,5	100	E13/G13
EAR27	23-27	8,5	100	P19
EAR28	25-28	9	100	E19/G19

Description:

Two-ear clips is an economical solution for simple hose assemblies. The two ears give the clip extra grip and help to maintain constant pressure around the hose.

Two-ear clips offer great versatility in simple hose assemblies.

Material: St 34 steel : Finish Silver-white Cr3 Zinc-Plated

HOSE CLAMPS

SIDE PINCER



Part No.	Side Pincer	Front Pincer	
PS01	•	•	 1

Description:

Suitable for Ear Clamps
Can be used either front or side access

STRAIGHT BLADE BAFFLES

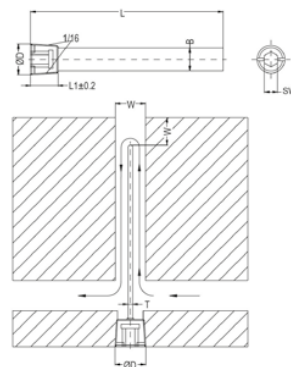
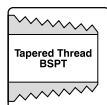

Part No	ØD (BSPT)	SW	W	B	L	L1	T
MB100-1/16	1/16"	4	6,5	6,2	104	8	1,61
MB200-1/16	1/16"	4	6,5	6,2	204	8	1,61
MB100-1/8	1/8"	5	8,5	8,2	104	8	1,61
MB200-1/8	1/8"	5	8,5	8,2	204	8	1,61
MB125-1/4	1/4"	7	11,5	11,2	131	10	2,43
MB250-1/4	1/4"	7	11,5	11,2	258	10	2,43
MB150-3/8	3/8"	8	15	14,2	156	10	2,43
MB300-3/8	3/8"	8	15	14,2	309	10	2,43
MB200-1/2	1/2"	10	18,5	18,2	207	10	2,43
MB400-1/2	1/2"	10	18,5	18,2	410	10	2,43
MB300-3/4	3/4"	12	23,5	23,2	309	12	3,21
MB500-3/4	3/4"	12	23,5	23,2	512	12	3,21

Description:

Material: MS58 Brass

SPIRAL BLADE BAFFLES

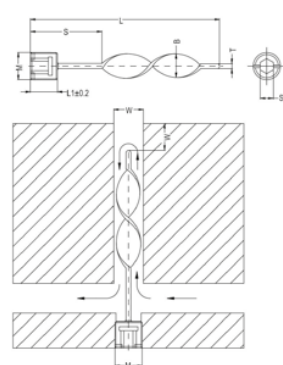
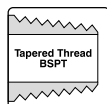

Part No	ØD (BSPT)	S	SW	W	B	L	L1	T
MSB100-1/16	1/16"	51	4	6,5	1/4"	101	8	1,61
MSB200-1/16	1/16"	102	4	6,5	1/4"	203	8	1,61
MSB100-1/8	1/8"	51	5	8,5	5/16"	101	8	1,61
MSB200-1/8	1/8"	102	5	8,5	5/16"	203	8	1,61
MSB125-1/4	1/4"	51	7	11,5	7/16"	127	10	2,43
MSB250-1/4	1/4"	102	7	11,5	7/16"	254	10	2,43
MSB150-3/8	3/8"	51	8	15	9/16"	152	10	2,43
MSB300-3/8	3/8"	102	8	15	9/16"	305	10	2,43
MSB200-1/2	1/2"	76	10	18,5	11/16"	203	10	2,43
MSB400-1/2	1/2"	127	10	18,5	11/16"	406	10	2,43
MSB300-3/4	3/4"	102	12	23,5	15/16"	305	12	3,21
MSB500-3/4	3/4"	153	12	23,5	15/16"	508	12	3,21

Description:

Material: MS58 Brass

FITTINGS

PARALLEL THREAD

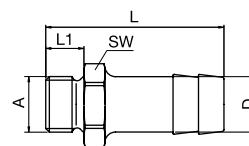

Part No.	A	D	L	L1	SW	
M10M8	M8x0,75	10	33,5	7	11	25
M10M10	M10x1	10	33,5	7	11	25
M10R1/8	1/8" BSP	10	33	7	14	25
M10R1/4	1/4" BSP	10	35	9	17	25
M13M12	M12x1,5	13	40	9	15	25
M13R1/4	1/4" BSP	13	42	9	17	25
M13M14	M14x1,5	13	43	10	17	10
M13M16	M16x1,5	13	40	9	17	10
M13R3/8	3/8" BSP	13	42	9	19	25
M19M24	M24x1,5	19	56	16	27	10
M19R1/2	1/2" BSP	19	54	12	24	10
M19R3/4	3/4" BSP	19	60	16	32	10

HOSE CONNECTOR WITH TAPER THREAD BSPT

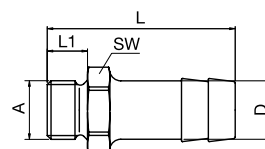

Part No.	A - BSPT	D (Inch)	D (mm)	L	SW	
MH02/04	1/8"	1/4"	6	34	10	25
MH02/06	1/8"	3/8"	10	34	12	25
MH04/04	1/4"	1/4"	6	37	14	25
MH04/06	1/4"	3/8"	10	37	14	25
MH04/08	1/4"	1/2"	13	37	14	25
MH06/06	3/8"	3/8"	10	37	17	25
MH06/08	3/8"	1/2"	13	37	17	25
MH06/10	3/8"	5/8"	16	40	17	25
MH06/12	3/8"	3/4"	19	44	21	25
MH08/06	1/2"	3/8"	10	40,5	21	25
MH08/08	1/2"	1/2"	13	40,5	21	25
MH08/12	1/2"	3/4"	19	46,5	21	25
MH08/16	1/2"	1"	25	50	27	25
MH12/06	3/4"	3/8"	10	42	27	10
MH12/08	3/4"	1/2"	13	42	27	10
MH12/12	3/4"	3/4"	19	48	27	10
MH12/16	3/4"	1"	25	50,5	27	10
MH16/08	1"	1/2"	13	45,5	34	10
MH16/12	1"	3/4"	19	54	34	10
MH16/16	1"	1"	25	54	34	10
MH24/20	1-1/2"	1-1/4"	32	58	48	10
MH24/24	1-1/2"	1-1/2"	38	58	48	10

PUSH LOCK - HOSETAIL CONNECTOR PARALLEL THREAD

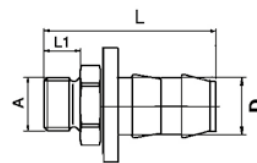

Part No.	A	D	L	L1	
P10R1/8	R1/8	10	39	7	10
P10R1/4	R1/4	10	39	7	10
P10M14	M14x1,5	10	42	7	10
P10R3/8	R3/8	10	43	7	10
P13R1/4	R1/4	13	39	10	10
P13R3/8	R3/8	13	43	10	10
P13R1/2	R1/2	13	43	10	10

FEMALE HOSE CONNECTOR

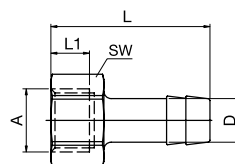

Part No.	A	D	L	L1	SW	
F10R1/8	1/8" BSP	10	33	8	14	25
F10R1/4	1/4" BSP	10	33	8	17	25
F10M14	M14x1,5	10	32	10	17	10
F13R1/4	1/4" BSP	13	39	8	17	25
F13M16	M16x1,5	13	40	10,5	22	10
F13R3/8	3/8" BSP	13	40	8	19	25

SWIVEL HOSE CONNECTOR

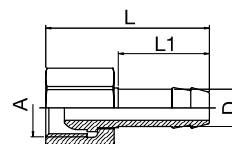

Part No.	A	D	L	L1	SW	
CM14	M14x1,5	9	39,5	22	17	10
CR1/4	G 1/4	9	39,5	22	17	10
CM16	M16x1,5	13	39	25	22	10
CR3/8	G 3/8	13	39	25	22	10
CR1/2	G 1/2	13	45	25	24	10
CM24	M24x1,5	19	52	32	30	10
CR3/4	G 3/4	19	52	32	32	10



See explanation of symbols on page 5

FITTINGS

EXTENDED CONNECTOR

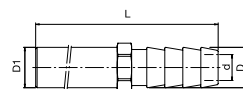

Part No.	D	D1	d	L	SW	
C120/10	10	10	6	120	11	10
C240/10	10	10	8	240	11	10
C150/13	13	14	9	150	15	10
C300/13	13	14	9	300	15	10

90° HOSE CONNECTOR

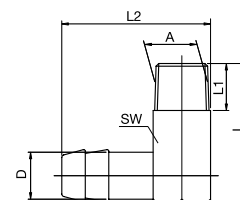

Part No.	A	D	L	L1	L2	SW	
V10M8	M8x0.75	10	27	9	33.5	11	25
V10M10	M10x1	10	27	9	28.5	11	25
V10R1/8	1/8" BSP	10	27	9	28.5	11	25
V10R1/4	1/4" BSP	10	34	11	40	15	25
V13R1/4	1/4" BSP	13	34	11	40	15	25
V13M14	M14x1.5	13	34	11	40	15	10
V13R3/8	3/8" BSP	13	35	12	42	17	25
V19M24	M24x1.5	19	47	16	58.5	24	10
V19R1/2	1/2" BSP	19	47	16	58.5	24	10

Description:
Nickle plated

TAPER THREAD BSPT

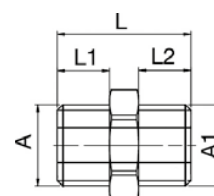
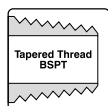

Part No.	A	A1	L	SW
EC02/02	1/8"	1/8"	23	10
EC04/04	1/4"	1/4"	29	14
EC06/06	3/8"	3/8"	29	17
EC08/08	1/2"	1/2"	35	21
EC12/12	3/4"	3/4"	37	27
EC16/16	1"	1"	43	34
EC20/20	1.1/4"	1.1/4"	46	42

DOUBLE NIPPLE

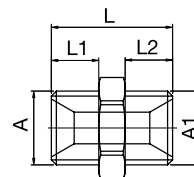

Part No.	A	A1	L	L1	L2	SW	
ZM14	M14x1,5	M14x1,5	23	9	9	17	10
ZM14-R1/4	M14x1,5	G 1/4	23	9	9	17	10
ZR1/4	G 1/4	G 1/4	23	9	9	17	10
ZM16	M16x1,5	M16x1,5	23	9	9	19	10
ZM16-R3/8	M16x1,5	G 3/8	23	9	9	19	10
ZR3/8	G 3/8	G 3/8	23	9	9	19	10
ZR1/2-M14	G 1/2	M14x1,5	27	12	9	22	10
ZR1/2-M16	G 1/2	M16x1,5	27	12	9	22	10
ZR1/2	G 1/2	G 1/2	30	12	12	22	10
ZM24-R1/2	M24x1,5	G 1/2	36	16	12	27	10
ZR3/4	G 3/4	G 3/4	40	16	16	27	10
ZR3/4-M24	G 3/4	M24x1,5	40	16	16	27	10

REDUCER NIPPLE

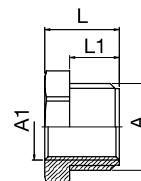

Part No.	A	A1	L	L1	SW	
GR1/4-R1/8	G 1/4"	G 1/8"	11	7	17	10
GM14-M10	M14x1,5	M10x1	11	7	17	10
GR3/8-R1/4	G 3/8"	G 1/4"	13	9	19	10
GM18-M14	M18x1,5	M14x1,5	14	9	22	10
GR1/2-R3/8	G 1/2"	G 3/8"	18	12	24	10
GR3/4-R1/2	G 3/4"	G 1/2"	24	16	27	10
GM24-M16	M24x1,5	M16x1,5	24	16	27	10
GR1/1-R3/4*	G 1"	G 3/4"	28	19	34	1
GR11/2-R3/4*	G 1-1/2"	G 3/4"	32	22	50	1
GR11/2-R1/1*	G 1-1/2"	G 1"	32	22	50	1

* without sealant coating

BARREL NIPPLE

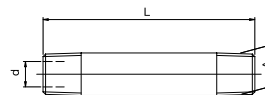
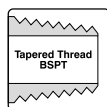

Part No.	T	L	d	
E50R1/8	1/8" BSPT	50	6	10
E100R1/8	1/8" BSPT	100	6	10
E150R1/8	1/8" BSPT	150	6	10
E200R1/8	1/8" BSPT	200	6	10
E50R1/4	1/4" BSPT	50	9	10
E100R1/4	1/4" BSPT	100	9	10
E150R1/4	1/4" BSPT	150	9	10
E200R1/4	1/4" BSPT	200	9	10
E100R3/8	3/8" BSPT	100	12	10
E150R3/8	3/8" BSPT	150	12	10
E200R3/8	3/8" BSPT	200	12	10

FITTINGS

EXTENSION NIPPLE

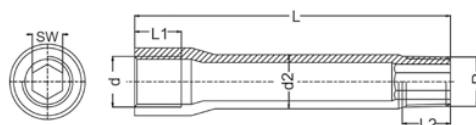

Part No.	d	R	d2	L	L1	L2	SW
EX18050	R1/8	R1/8	10	50	12	10	5
EX18075	R1/8	R1/8	10	75	12	10	5
EX18100	R1/8	R1/8	10	100	12	10	5
EX18125	R1/8	R1/8	10	125	12	10	5
EX14050	R1/4	R1/4	14	50	12	10	8
EX14075	R1/4	R1/4	14	75	12	10	8
EX14100	R1/4	R1/4	14	100	12	10	8
EX14125	R1/4	R1/4	14	125	12	10	8
EX14150	R1/4	R1/4	14	150	12	10	8

Description

Material: Zinc Plated Steel

PRESSURE PLUG CONICAL

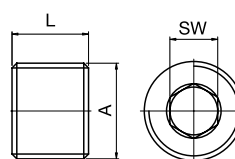
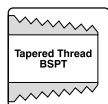

Part No.	A	L	SW	
RM8	M8x0,75	8	4	100
RM10	M10x1	8	5	100
R1/8	1/8" BSPT	8	5	100
RM12	M12x1,5	8	6	100
R1/4	1/4" BSPT	10	7	100
RM14	M14x1,5	10	7	100
R3/8	3/8" BSPT	10	8	100
R1/2	1/2" BSPT	10	10	100

PRESSURE PLUG CYLINDRICAL

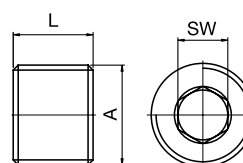

Part No.	A	L	SW	
RM8C	M8x0,75	8	4	100
RM10C	M10x1	8	5	100
R1/8C	1/8" BSP	8	5	100
RM12C	M12x1,5	8	6	100
R1/4C	1/4" BSP	10	7	100
RM14C	M14x1,5	10	7	100
R3/8C	3/8" BSP	10	8	100
R1/2C	1/2" BSP	10	10	100

HEX PLUG

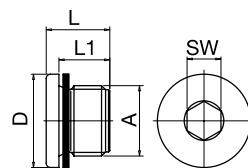

Part No.	A	D	L	L1	SW	
DM10	M10x1	14	11	8	5	25
DR1/8	G 1/8	14	11	8	5	25
DM12	M12x1,5	17	15	12	6	25
DR1/4	G 1/4	18	15	12	6	25
DM14	M14x1,5	19	15	12	6	25
DR3/8	G 3/8	22	15	12	8	25
DR1/2	G 1/2	26	18	14	10	25
DR3/4	G3/4"	32	21	16	12	1
DR1	G1"	40	22,5	16	17	1
DR1-1/2*	G1-1/2"	55	22,5	16	24	1

CHANNEL PLUG

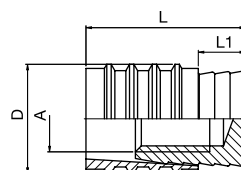

Part No.	A	D	L	L1	
S6	M3	6	11,5	3,5	100
S8	M4	8	11,5	3,5	100
S10-1	M6	10	14	4	100
S12	M6	12	14	4	100
S16	M8	16	16	4	100

CHANNEL PLUG

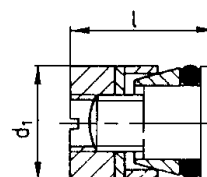

Part No.	d1	Length	
KN105-6	6	10	25
KN105-8	8	11	25
KN105-10	10	11	25
KN105-12	12	11	25
KN105-14	14	13	25
KN105-16	16	13	25

Description

Material: Brass
O-ring Viton