

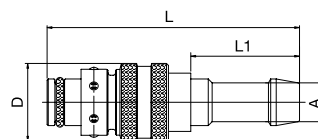

MOULDPRO

FRENCH SERIES

STRAIGHT COUPLING



S	Series	↔	A	D	L	L1	SW	
8	08	08K8	8	20	65	28		10
		08K10	10	20	65	28		10
		08K12	13	20	65	28		10
12	12	12K13	13	28	77	33		10
		12K16	16	28	77	33		10

STRAIGHT COUPLING - PUSH LOCK

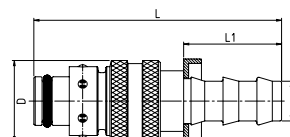
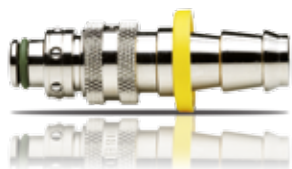
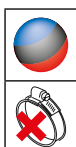

S	Series	↔	A	D	L	L1	SV	
8	8	08K10-PL	10	20	61,5	24,5		10
		08K12-PL	13	20	65	28		10
12	12	12K13-PL	13	28	77	33		10

90° COUPLING

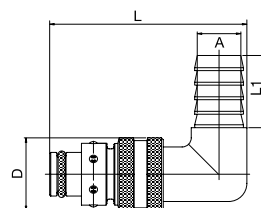

S	Series	↔	A	D	L	L1	SW	
8	08	08K10/90	10	20	51	20		10
		08K12/90	13	20	51	20		10
12	12	12K13/90	13	28	59	25		10
		12K16/90	13	28	62	25		10

See explanation of symbols on page 5

90° COUPLING - PUSH LOCK

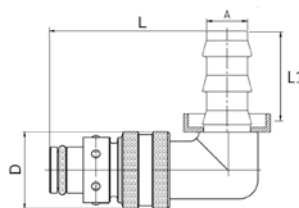
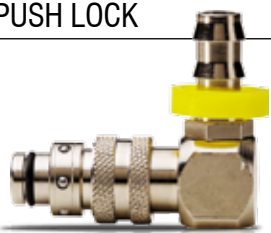

S	Series	↔	A	D	L	L1	SW	
8	8	08K10/90-PL	10	20	51	20		10
		08K12/90-PL	13	20	51	20		10
12	12	12K13/90-PL	13	28	59	25		10
		12K16/90-PL	13	28	62	25		10

45° COUPLING

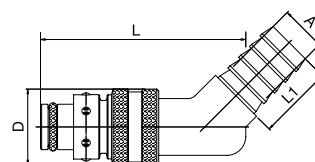

S	Series	↔	A	D	L	L1	SW	
8	8	08K10/45	10	20	51	20		10
		08K12/45	13	20	51	20		10
12	12	12K13/45	13	28	55	25		5
		12K16/45	13	28	55	25		5

45° COUPLING - PUSH LOCK

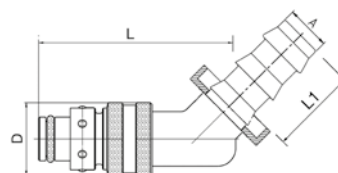

S	Series	↔	A	D	L	L1	SW	
8	8	08K10/45-PL	10	20	51	20		10
		08K12/45-PL	13	20	51	20		10
12	12	12K13/45-PL	13	28	55	25		5
		12K16/45-PL	13	28	55	25		5

FEMALE THREADED COUPLING

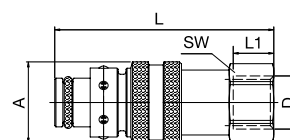

S	Series	↔	A	D	L	L1	SW	
8	8	08K1R1/4	20	G1/4	43	15		10
12	12	12K1R3/8	20	G1/2	60	20		10

FRENCH SERIES

MALE PLUG

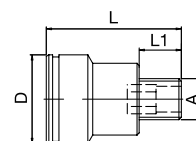

S	Series	↔	A	D	L	L1	SW	
⑧	08	08NM10	M10x1	21	32	10	6	25
		08NR1/8	G1/8	21	32	10	6	25
		08NR1/4	G1/4	21	33	12	8	25
		08NR3/8	G3/8	21	24	13	8	25
⑫	12	12NR3/8	G3/8	32	41	13	10	10
		12NR1/2	G1/2	32	44	16	14	10
		12NR3/4	G3/4	32	32	19	14	10

FEMALE PLUG

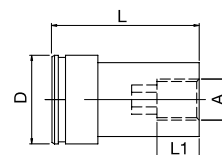

S	Series	↔	A	D	L	L1	SW	
⑧	08	08NR1/8I	G1/8	21	35	10	6	10
		08NR1/4I	G1/4	21	40	14	8	10
⑫	12	12NR3/8I	G3/8	32	49	14	12	10
		12NR1/2I	G1/2	32	50	14	12	10

90° PLUG

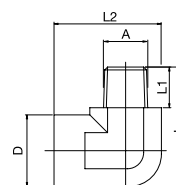

S	Series	↔	A	D	L	L1	L2	SW	
⑧	08	08NR1/8/90	R1/8	22	34	11	33		10
		08NR1/4/90	R1/4	22	37	13	33		10
		08NR3/8/90	R3/8	22	37	13	33		10

45° PLUG

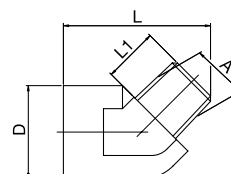

S	Series	↔	A	D	L	L1	L2	SW	
⑧	08	08NR1/8/45	R1/8	22	33	10,5			10
		08NR1/4/45	R1/4	22	33	10,5			10



See explanation of symbols on page 5

EXTENDED PLUG

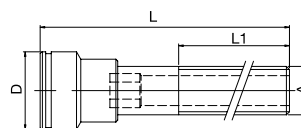

S	Series	↔	A	D	L	L1	SW	
8	08	08NR1/8/50	G1/8	21	50	28	6	10
		08NR1/8/100	G1/8	21	100	60	6	10
		08NR1/8/150	G1/8	21	150	60	6	10
		08NR1/4/50	G1/4	21	50	28	8	10
		08NR1/4/100	G1/4	21	100	60	8	10
		08NR1/4/150	G1/4	21	150	60	8	10
		08NR1/4/200	G1/4	21	200	60	8	10

COUPLING COLOUR TAGS



	Series	Part No.	Colour	
Colour Clip for couplers/für Kupplungen/pour coupleurs	08	08KR		10
Colour Clip for couplers/für Kupplungen/pour coupleurs		08KB		10
Colour Clip for couplers/für Kupplungen/pour coupleurs		08KS		10
Colour Clip for couplers/für Kupplungen/pour coupleurs	12	12KR		10
Colour Clip for couplers/für Kupplungen/pour coupleurs		12KB		10
Colour Clip for couplers/für Kupplungen/pour coupleurs		12KS		10

PLUG COLOUR TAGS



	Series	Part No.	Colour	
Colour Clip for connectors/für Stecknippel/pour abouts	08	08NR		10
Colour Clip for connectors/für Stecknippel/pour abouts		08NB		10
Colour Clip for connectors/für Stecknippel/pour abouts		08NS		10
Colour Clip for connectors/für Stecknippel/pour abouts	12	12NR		10
Colour Clip for connectors/für Stecknippel/pour abouts		12NB		10
Colour Clip for connectors/für Stecknippel/pour abouts		12NS		10

REPLACEMENT SEALS VITON +200° C

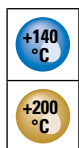

Part No.	Series	S	
08V	8	8	10
12V	12	12	10

FRENCH MATIC SERIES

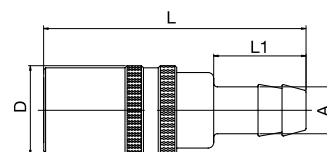

STRAIGHT COUPLING

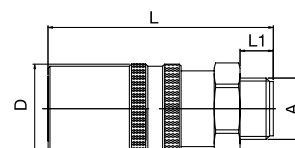

S	Series		A	D	L	L1	
6	6	F6K8V	8	20	58	22	10
9	9	F9K12V	12	24	71	25	10
12	12	F12K16V	16	32	90,5	32	10
16	16	F16K19V	19	38	112,5	36	5

MALE THREADED COUPLING



S	Series		A	D	L	L1	
6	6	F6KUR1/4V	G 1/4	20	54	9	10
9	9	F9KUR3/8V	G 3/8	24	61,0	9	10
12	12	F12KUR1/2V	G 1/2	32	74,5	12	10
16	16	F16KUR3/4V	G 3/4	38	90,5	16	5
25	25	F25KUR1/1V	G 1	60	144	20	1
		F25KUR1-1/4V	G 1-1/4	60	144	21	1

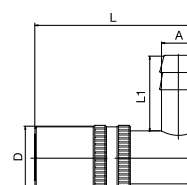

90° COUPLING



S	Series		A	D	L	L1	
6	6	F6K8V/90	8	20	60,5	22	10
9	9	F9K10V/90	10	24	60,5	22	10
		F9K12V/90	12	24	60,5	28,5	10

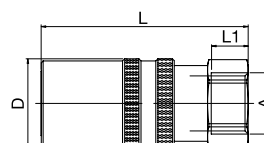

FEMALE THREADED COUPLING



S	Series		A	D	L	L1	
6	6	F6KIR1/4V	20	47	10	G1/4	10
9	9	F9KIR3/8V	24	56	10	G 3/8	10
12	12	F12KIR1/2V	32	59,5	12	G 1/2	10
16	16	F16KIR3/4V	38	90,5	16	G 3/4	5
25	25	F25KIR1/1V	G 1	60	140	20	1
		F25KIR1-1/4V	G 1-1/4	60	140	21	1

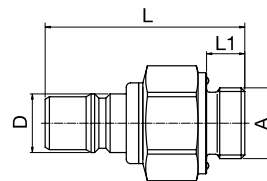

VALVED PLUG



S	Series		A	D	L	L1	SW	
⑥	6	F6NR1/8V	G 1/8	9,4	45	7	17	10
⑨	9	F9NR1/4V	G 1/4	13,8	49	9	19	10
		F9NR3/8V	G 3/8	13,8	47	9	24	10
		F9NR1/2V	G 1/2	13,8	50	12	27	10
⑫	12	F12NR3/8V	G 3/8	17,8	61	9	24	10
		F12NR1/2V	G 1/2	17,8	62	12	27	10
		F12NR3/4V	G 3/4	17,8	64	16	34	10
⑯	16	F16NR3/4V	G 3/4	22,4	81	16	34	5
		F16NR1/1V	G 1	22,4	84	19	41	5
⑳	25	F25NR1/1V	G 1	36	127	20	50	1
		F25NR1-1/4V	G 1 1/4	36	131,5	20	50	1

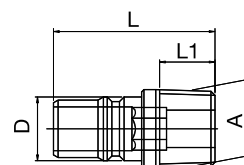
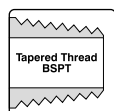

MALE PLUG WITH INNER HEX



S	Series		A	D	L	L1	SW	
⑥	6	F6NR1/8	G 1/8 BSPT	10	30	9	5	10
⑨	9	F9NR1/4	R 1/4 BSPT	13,8	35	12	8	10
		F9NR3/8	R 3/8 BSPT	13,8	35	12	8	10
⑫	12	F12NR3/8	R 3/8 BSPT	17,8	40	12	10	10

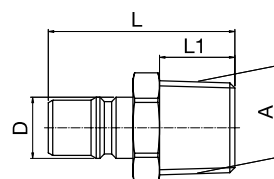
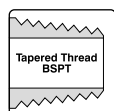

MALE PLUG TAPER THREAD

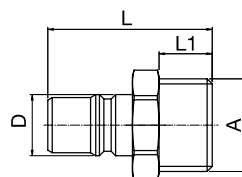
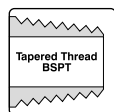

S	Series		A	D	L	L1	SW	
⑫	12	F12NR1/2	R 1/2 BSPT	17,8	42	17	22	10
⑯	16	F16NR3/4	R 3/4 BSPT	22,4	59	19	27	10

VALVED PLUG SHORT MODEL



S	Series		A	D	L	L1	SW	
⑨	9	F9NR1/2V-S	G 1/2	13,8	37	12	22	10
⑫	12	F12NR3/4V-S	G 3/4	17,8	46	16	27	10

FRENCH MATIC SERIES

MALE PLUG

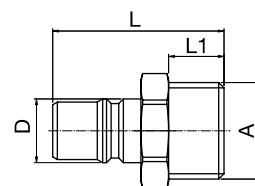

S	Series	↔	A	D	L	L1	SW	
⑨	9	F9NR1/2	G 1/2 BSP	13,8	37	12	22	10
⑫	12	F12NR3/4	G 3/4 BSP	17,8	46	16	27	10

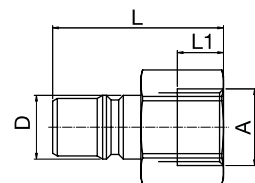

FEMALE PLUG

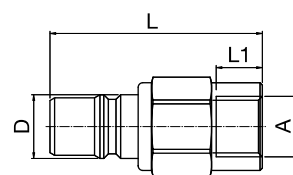

S	Series	↔	A	D	L	L1	SW	
⑥	6	F6NR1/4I	G 1/4	9,4	34	11	17	10
⑨	9	F9NR3/8I	G 3/8	13,8	37	10	22	10
⑫	12	F12NR1/2I	G 1/2	17,8	45	12	27	10
⑫	25	F25NR1/1I	G 1	36	100	20	41	1

FEMALE PLUG VALVED



S	Series		A	D	L	L1	SW	
⑨	9	F9NR1/4VI	G 1/4	13,8	46	10	19	10
		F9NR3/8VI	G 3/8	13,8	48	10	22	10
⑫	16	F16NR3/4VI	G 3/4	22,4	80,5	16	32	5
⑫	25	F25NR1/1VI	G 1	36	148,5	20	50	1
		F25NR1-1/4VI	G 1-1/4	36	158	20	50	1